

DHI-ICS1-W2(868)

Smart Plug



The Smart Plug is a highly intuitive power switch. It can be remotely controlled through the mobile app, scheduled to turn on and off, and set to activate automatically when alarms are triggered or the system is armed or disarmed.

Scene

Suitable for scenes where remote control, electrical safety and energy efficiency are prioritized such as houses, stores and office buildings.

Technical Specification

Port

Relay Output	1 port, NO/NC (100–240 VAC, max 16 A)
--------------	---------------------------------------

Wireless

Indicator Light	1 indicator light, displays multiple status Flash green: pairing Solid green: the circuit is closed Light off: the circuit is open
Remote Update	Supports cloud update
Button	1 button, perform multiple operations (open/close the circuit, restore to the factory settings and pair)
Signal Strength	Supports detecting signal strength.
Frequency Range	868-868.6 MHz
Communication Distance	In an open environment: 1,600 m (5249.34 ft)
MAX Power	865-868.6 MHz@16.15 dBm
Communication Mechanism	Two-way communication.
Encryption	AES-128
Frequency Hopping	Yes

- Two-way RF communication.
- Displays the status with an LED indicator.
- Supports cloud update and auto recovery after an update fails.
- Offers protection against overcurrent, overvoltage, and overheating.
- Measure the voltage, current and temperature.
- Generates power consumption statistics and it can be reset to clear the statistics.
- Output control mode can be selected between bistable and pulse modes.

General

Operating Temperature	Indoor: -10 °C to +55 °C (+14 °F to +131 °F)
Operating Humidity	10%–90%(RH), non-condensing
Storage Temperature	-10 °C to +55 °C (+14 °F to +131 °F)
Storage Humidity	10%–90%(RH), non-condensing
Power Supply	100–240 VAC, 50/60 Hz
Product Dimensions	52 mm × 52 mm × 82 mm (2.05" × 2.05" × 8.32") (L × W × H)
Installation	With power strip/2 Pin
Net Weight	83 g (0.18 lb)
Power Consumption	0.3 W
Certifications	CE
Casing Material	PC

Data Monitoring

Data Monitoring	Yes
Data Type	Current; voltage; temperature

Accuracy

Current Measurement Accuracy	Protection range: 0 A–16 A Measurement Accuracy: level 1.0 and above.
Voltage Measurement Accuracy	Protection range: 0 V –250 V Measurement Accuracy: level 1.0 and above.
Internal Temperature Monitoring Accuracy	Protection range: 0°C –55 °C Measurement Accuracy: ±2% or ±2 °C

Alarm

Alarm Type	Alarm for overcurrent, overvoltage, and overheating
------------	---

Smart Plug | DHI-ICS1-W2(868)

Ordering Information

Type	Model	Description
Smart Plug	DHI-ICS1-W2(868)	Smart Plug

Installation

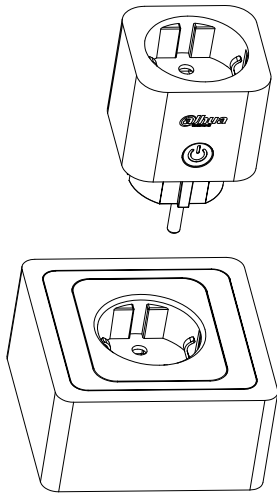

Application

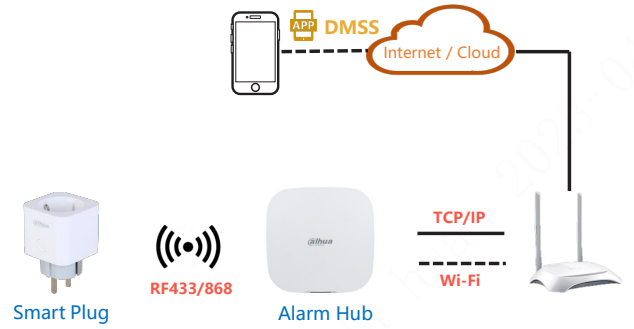

Dimensions (mm[inch])

